



LICENSED MORTGAGE BROKER

SOUTHEAST PROPERTIES

LICENSED REAL ESTATE BROKER

A Commercial Real Estate Development Company

(888) 532-LEASE (5327)

LAUDERHILL CITY CENTER

589,700 (GLA)

CITY OF LAUDERHILL, FLORIDA

LOCATED ON STATE ROAD 7 (441)

Just North of Sunrise Blvd. between N.W. 12th St. & N.W. 16th St.

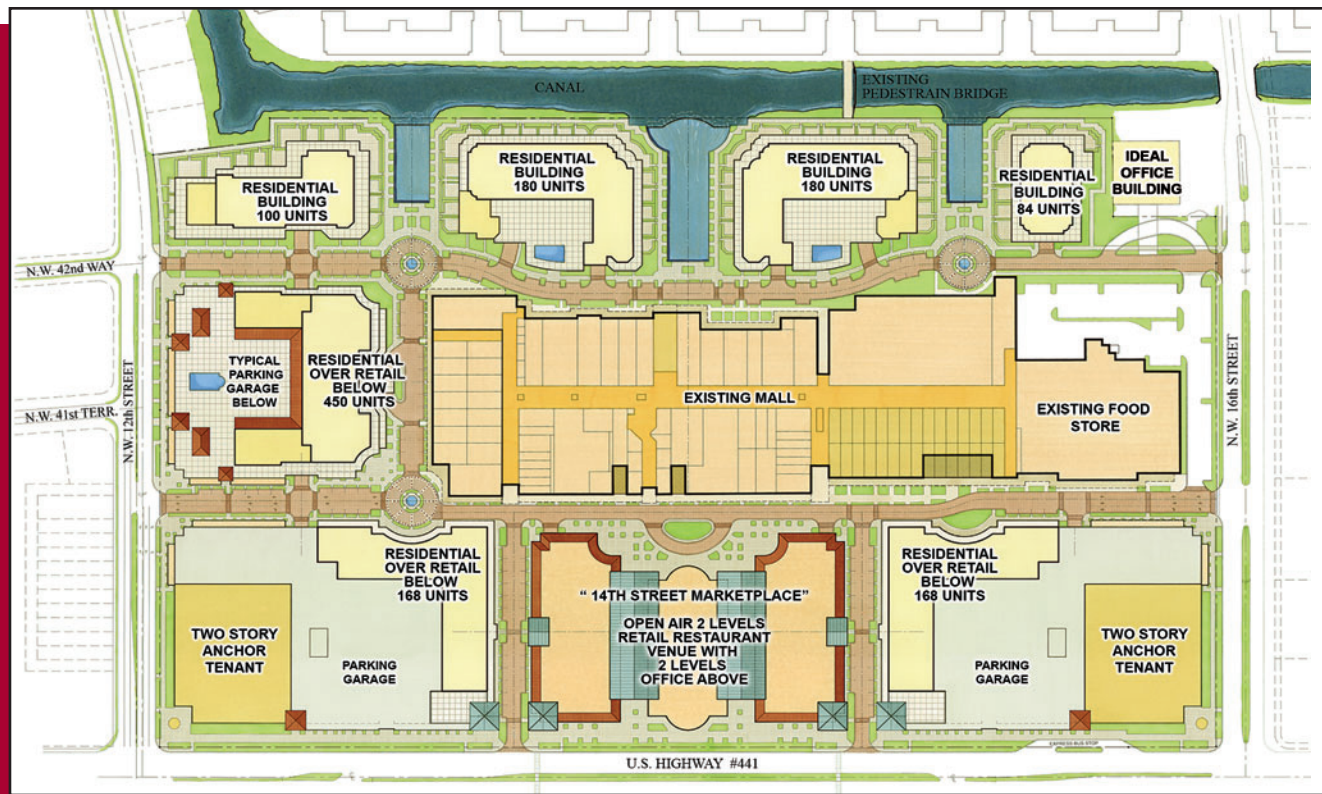

UNDER RENOVATION AND REDEVELOPMENT

**GREAT LOCATION
CENTRAL BROWARD COUNTY
WITH EASY ACCESS TO I-95 AND
THE FLORIDA TURNPIKE**

- ❖ TRAFFIC COUNT: Over 52,500 Daily
- ❖ POPULATION: 186,155 in 3 Mile Radius
- ❖ AVERAGE HH INCOME: \$49,351
- ❖ MEDIAN AGE: 35 years old

